

# Waco Convention Center

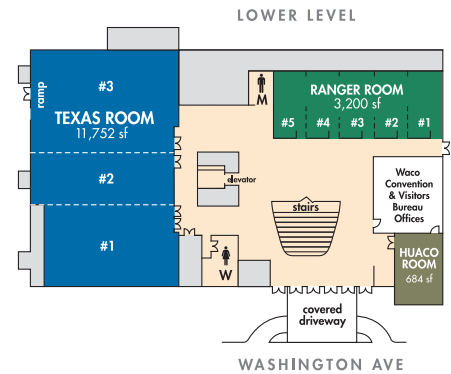

UPPER LEVEL

LOWER LEVEL

Set-up Capacities										Rental*		
Room	Dimensions	Ceiling Height	Sq Ft	Theatre	Banquet Rounds	Banquet Rect.	Class-room	Dance	10'x10' Booths	All Day	Six Hours	Maint. fee (per day)
CHISHOLM HALL	150' x 204'	32'	32,000	2,500	1,900	2,500	1,200	2,100	180	\$1200	\$825	\$20
McLENNAN HALL	77' x 179'	20'	15,000	1,200	800	1,000	500	800	80	\$475	\$400	\$10
1/3 McLENNAN	77' x 60'	20'	5,000	400	200	300	165	250	25	\$375	\$375	
2/3 McLENNAN	77' x 120'	20'	10,000	800	536	576	480	522	50	\$375	\$375	
BRAZOS ROOM	100' x 150'	18'	15,000	1,200	800	1,000	500	800	74	\$475	\$400	\$10
1/2 BRAZOS	100' x 75'	18'	7,500	600	336	400	250	300	35	\$350	\$350	
TEXAS ROOM	138' x 86'	9'	11,752	800	544	640	350	600	48	\$350	\$300	\$10
TEXAS 1	80' x 48'	9'	3,840	250	150	200	120	96	16	\$275	\$275	
TEXAS 2	86' x 30'	9'	2,580	150	72	125	56	N/A	11	\$275	\$275	
TEXAS 3	86' x 62'	9'	5,332	350	150	250	140	104	21	\$275	\$275	
RANGER ROOM	98' x 34'	9'	3,200	250	160	176	140	N/A	N/A	\$200	\$125	\$10
1/5 RANGER	34' x 19'	9'	640	50	N/A	N/A	28	N/A	N/A	\$200	\$125	
BOSQUE THEATER	Fixed seats	14'	2,500	172	N/A	N/A	N/A	N/A	N/A	\$375	\$300	\$10
DeCORDOVA ROOM	56' x 20'	10'	1,160	110	40	48	52	N/A	N/A	\$100	\$100	\$10
CAMERON ROOM	32' x 30'	9'	896	74	32	40	52	N/A	N/A	\$100	\$100	\$10
HUACO ROOM	19' x 36'	8'	684	—FIXED CONFERENCE TABLE, SEATS 24—						\$100	\$100	\$10
ENTIRE BUILDING	119,000 (includes lobby areas—excludes garage)									\$2000		\$100

Common Set-up charges		
	Advance Orders	Floor Order (day of event)
Rectangle Tables: 8'		
with plastic top	\$8.00	\$16.00
with cloth skirt	\$15.00	\$30.00
with cloth skirt and cloth cover	\$25.00	\$50.00
Round Tables: 5' uncovered	\$8.00	\$16.00
linen covered	\$25.00	\$50.00
Padded Chairs	\$1.00	\$2.00
White Folding Chairs	\$2.00	\$4.00
Stages (per section)	\$25.00	\$50.00
Catering Fee	15%	N/A

\*Prices listed are for room rental only. There is a set-up charge for tables and chairs (see chart at left). Additional charges may include security, electrical for exhibits or bands, angled tables or chairs, audio-visual equipment, drayage and storage. All day rental is from 8 AM to 12 midnight—there is an extra charge for rentals beyond these hours. Other services include in-house limited catering, bar service and concessions. The Waco Convention Center has exclusive rights to serve all alcoholic beverages, including champagne, mixed beverages, beer and wine.

NOTE on set-up capacities: Banquet round set-up assumes 5' rounds set with 8 per table. The Center has a limited number of round tables. Classroom set-up assumes 4 people per 8' rectangle table. Dance set-up assumes rectangle tables, set 8 per table, with no head table. All set-up capacities are approximate and will vary depending on the specific needs of the client. Texas and Cameron Rooms have columns in them.

The Waco Convention Center is seven blocks from I-35. Take exit 335B at University Parks Drive and follow the signs to the Convention Center, conveniently located at the corner of University Parks Drive and Washington Avenue.



**Waco Convention Center**  
 100 Washington Avenue  
 PO Box 2570  
 Waco, Texas 76702-2570  
 800-321-9226  
 254-750-5810  
 254-750-5801 (fax)  
[www.wacocvb.com](http://www.wacocvb.com)  
[visitus@wacocvb.com](mailto:visitus@wacocvb.com)